

MODEL 200 SHOWN

ASSEMBLY INSTRUCTIONS

Your POWER-TRIM is shipped with all bolts in the proper place for assembly; they need only to be removed and assembled according to the following guide.

1. Remove the two lower bolts on the handle (#1). Pivot handle on remaining two bolts to the proper position and insert the bolts into the same hole. Tighten all four handle bolts.
2. Take the control plate assembly (#2) and assemble to handle in position shown in picture.
3. Remove the cotter pin in the control Rod (#3) and insert Rod into side bracket, using washer on each side of the flat bar. Replace cotter pin.
4. Place throttle cable under cable clip (#4).
5. Assemble lifting handle into position shown in picture, being careful not to tighten bolt in engine too tight (#5). (This handle not supplied with Honda engine models or Model 150).

NOTE: Some models are shipped with the handle completely removed. In this case position the handle as shown, insert all four bolts and tighten. Remove the two small throttle screws, position the throttle control as shown and tighten the screws.

Power Trim EDGERS

**INSTRUCTION MANUAL
FOR MODELS**

200	300-H	308
300	150	308-H
200-H	208-H	208-V

IMPORTANT

Before operating this machine, be sure operator has familiarized himself with Safety and Operating instructions contained in this manual.

NOTICE

This equipment is not equipped with a spark arresting muffler. Certain states require an approved arresting muffler should this equipment be operated in or near forest areas, brush covered or grassy areas, which could catch fire from a spark leaving the muffler.



WARNING:



The engine exhaust from this product contains chemicals known to the State of California to cause cancer, birth defects, or other reproductive harm.

OPERATING SAFETY INSTRUCTIONS

CAUTION — WEAR SAFETY GLASSES OR GOGGLES WHEN OPERATING THIS MACHINE.

1. Do not operate product when barefoot or wearing open sandals. Always wear safety footwear, and pants or slacks that cover your legs.
2. DO NOT use product on graveled surfaces.
3. Never operate the product without good visibility or light.
4. Start the engine carefully. Make certain all attachments are disengaged before attempting to start. Keep hands, feet, clothing and the like well away from cutting member and other moving parts.
5. DO NOT run the engine indoors, exhaust fumes are dangerous.
6. Never attempt to make any adjustments while engine is running. (Except where specifically recommended in these instructions.)
7. Never direct discharge of material toward bystanders nor allow anyone near the area of operation. Use care in directing discharge to avoid glass enclosures, automobiles and the like.
8. Stay alert for uneven sidewalks, holes in terrain or other unstable conditions when using product. Always push the machine slowly over rough ground.
9. Object struck by the cutting member can cause injuries. The lawn should always be carefully examined and clear of all objects prior to edging or trimming. If the blade strikes a foreign object follow these steps:
 1. Stop the machine.
 2. Disconnect spark plug wire.
 3. Inspect for damage.
 4. Repair any damage before restarting and operating the product.
10. Disengage the cutting member when the product is transported or not in use. Take all possible precautions when leaving the machine unattended. Disengage attachments and stop the engine.
11. When cleaning, repairing or inspecting, make certain the cutting member and all moving parts have stopped. Disconnect the spark plug wire and keep the wire away from the plug so that unintentional starting doesn't occur.
12. Never operate the product without guards, plates or other protective devices in place.

13. Use only accessories and attachments supplied or specifically recommended by the manufacturer.
14. Do not operate product with a damaged or excessively worn cutting member.
15. Do not change the engine governor settings or overspeed the engine.
16. If the product vibrates abnormally, immediately stop the engine and check for the cause. Vibration is generally a warning of trouble.
17. **CAUTION** Operate the product from position where guards block the line of sight to the cutting member.

SAVE THESE INSTRUCTIONS IMPORTANT GENERAL SAFETY INSTRUCTIONS

DANGER When using your edger follow basic precautions, including the following:

1. **DRESS PROPERLY, WEAR SAFETY GLASSES OR GOGGLES.** Do not wear loose clothing or jewelry. They can be caught in moving parts. Use of sturdy gloves and safety footwear is recommended.
2. **READ AND FOLLOW ALL ENCLOSED INSTRUCTIONS.** Read the instruction manual carefully. Be thoroughly familiar with the controls and the proper use of the equipment. Know how to stop the unit and disengage the controls.
3. **DANGER — ROTATING CUTTING MEMBER.** Keep both hands on the handles when blade is rotating. Keep feet away from cutting area. Do not attempt to remove cut material nor hold material to be cut when engine is running or when cutting member is moving. Make sure spark plug is disconnected when clearing jammed material from cutting member.
CAUTION—Cutting member coasts after turn off.
4. **KEEP OPERATING AREA CLEAR.** Keep the area clear of all persons, particularly small children and pets.
5. **STAY ALERT.** Watch what you are doing and use common sense. Do not operate the edger when fatigued or under the influence of alcohol or drugs.
6. **USE EDGER PROPERLY.** Use only for edging or trimming the type of shrubs, grass and other growth for which the machine is designed. Do not abuse the edger. Do not use product in rain or wet locations. Never allow children to operate the product. Never allow adults to operate the product without proper instruction.

(Continued on next page)

POWER TRIM FEATURES AND CONTROLS

7. DON'T OVER-REACH OR STAND ON UNSTABLE SUPPORT. Keep good footing and balance at all times.

8. MAINTAIN PRODUCT WITH CARE. Follow maintenance instructions given in manual. To reduce the risk of fire, do not allow excessive grass, leaves or grease to accumulate on the product.

9. STORE PRODUCT INDOORS. When not in use, store edger indoors in a dry place, locked or otherwise inaccessible to children.

10. DO NOT ATTEMPT TO REPAIR THE PRODUCT. Have repairs made by only a qualified dealer or repairman. See that only identical replacement parts are used.

11. HANDLE FUEL WITH CARE, IT IS HIGHLY FLAMMABLE. Use a fuel container that is acceptable for the purpose. Never add fuel to a running or hot engine. Fill fuel tank outdoors with extreme care. Never fill fuel tank indoors. Replace gasoline cap tightly. If fuel is spilled, move product and fuel container from area and do not create a source of ignition.

HEALTH WARNING

GASOLINE

Harmful or fatal if swallowed.
Long-term exposure to vapors has caused cancer in laboratory animals.

- Avoid prolonged breathing of vapors.
 - Keep face away from nozzle and gas tank/container opening.
 - Keep away from eyes and skin.
 - Never siphon by mouth.
- Failure to use caution may cause serious injury or illness.

WARNING

CHEMICALS KNOWN TO THE STATE TO CAUSE CANCER, BIRTH DEFECTS, OR OTHER REPRODUCTIVE HARM ARE FOUND IN GASOLINE, CRUDE OIL, AND MANY OTHER PETROLEUM PRODUCTS AND THEIR VAPORS, OR RESULT FROM THEIR USE.

READ AND FOLLOW LABEL DIRECTIONS AND USE CARE WHEN HANDLING OR USING ALL PETROLEUM PRODUCTS.

(CALIFORNIA HEALTH AND SAFETY CODE SECTION 25249.6)

WARNING

Do not use edger replacement blades of an inferior quality. Blade failure could occur. Use only original equipment POWER TRIM blades.

SAVE THESE INSTRUCTIONS

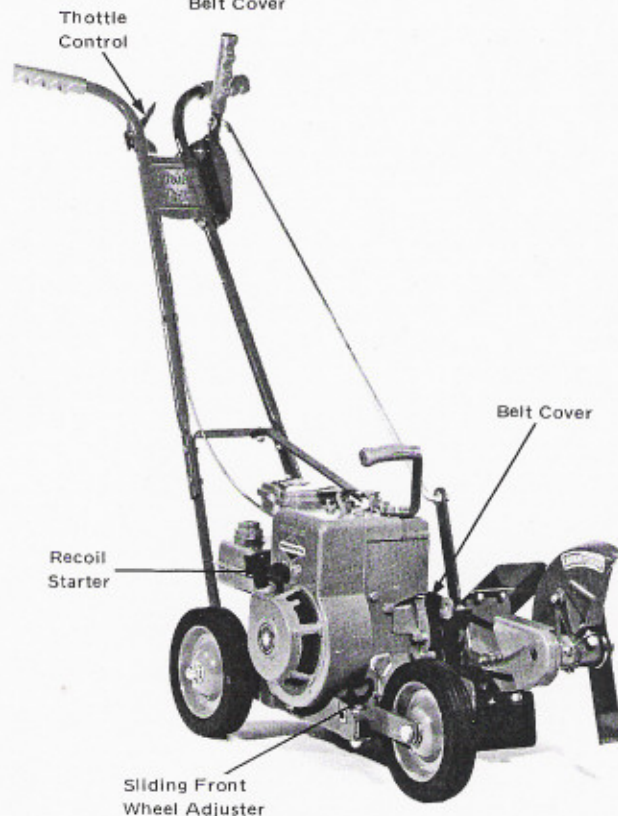
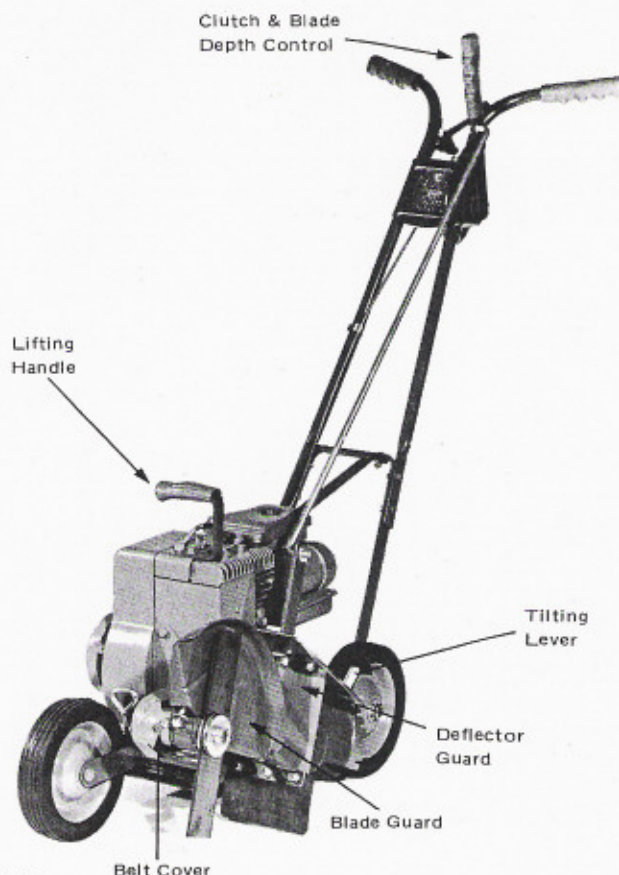

MODEL 200 SHOWN

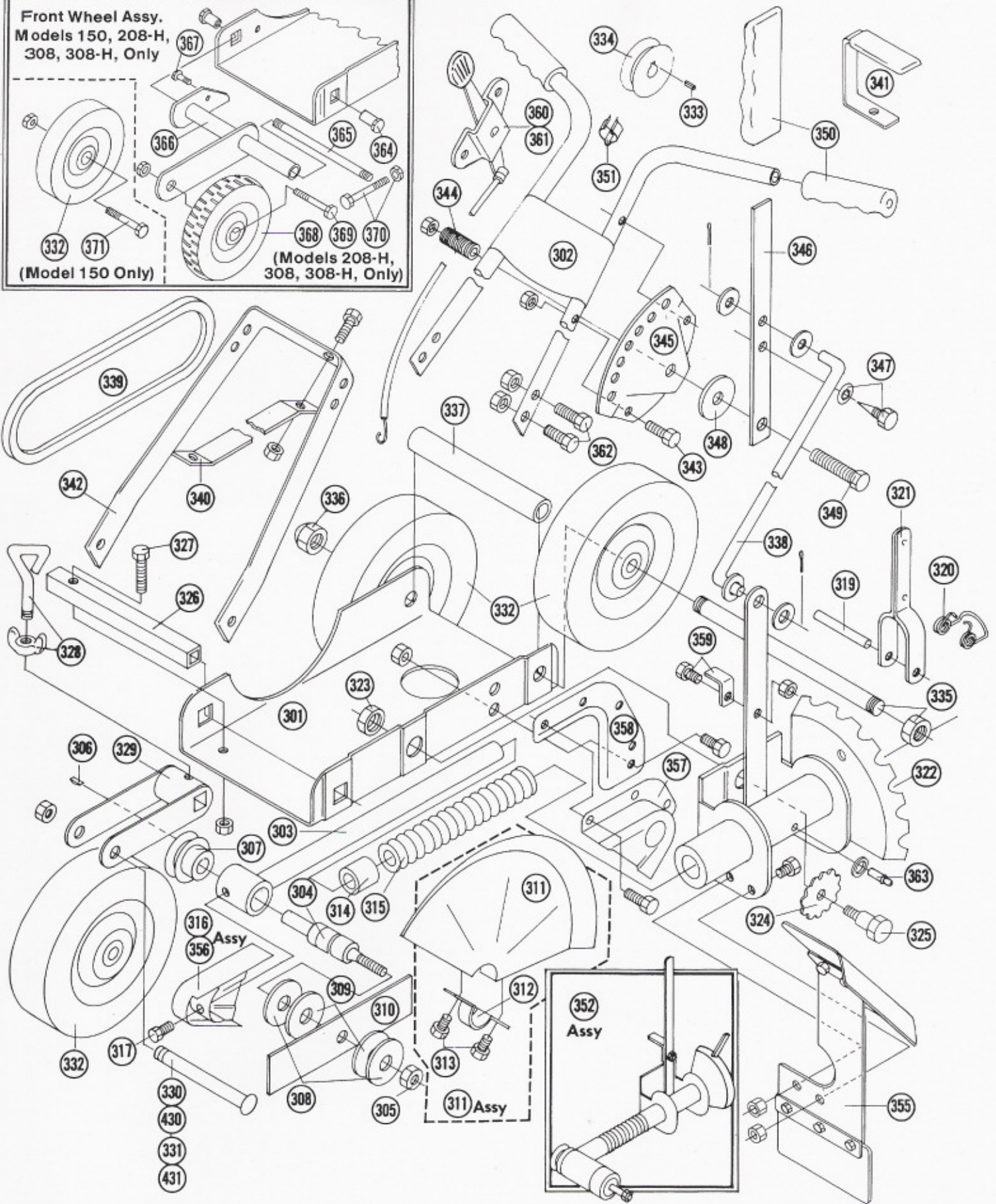
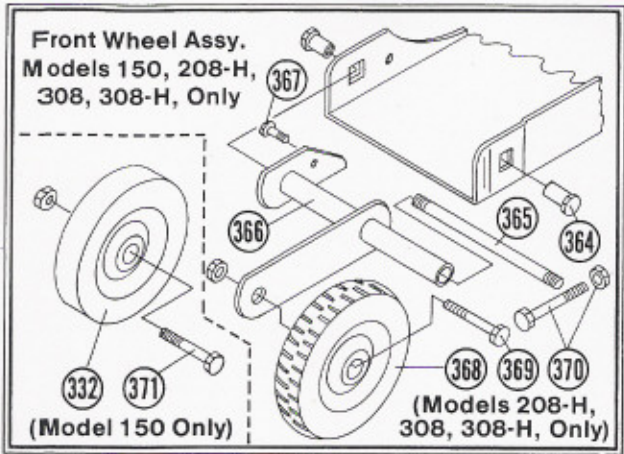

MODELS 200, 300, 200-H, 300-H, 150, 208-H, 308, 308-H, 208-V

POWER-TRIM EDGER

PARTS LIST FOR MODEL 200, 300, 200-H, 300-H, 150, 208-H, 308, 308-H, 208-V

Part No.	Part No.
301 Base	339 28" V-Belt
302 Handle	339-1 H.D. Notched V-Belt
303 Mandrel Arm	**340 Motor Brace
304 Bearing & Shaft with Nut, Key	340-1 Motor Brace, Fits Honda G-100
305 Shaft Nut	340-2 Motor Brace, Fits Honda 3.5 H.P.
306 Woodruff Key	340-3 Motor Brace, Fits 90000
307 2" Pulley	Series Briggs Engines
308P Steel Blade Washer (2) each	341 Handle with Grip
309 Fibre Blade Washer (2) each	342 Handle Extension
310 2" x 10" x 1/2" Blade	342-1 Handle Extension, Fits
311 Assembly, Complete Guard	Briggs 3.5 H.P. R-Tank
311-B Guard Support Bracket	343 Bolt with Nut (2) each
312 Guard Clamp	344 Spring
313 Bolts, with Nuts (2) each	345 Adjusting Plate
314 Spring Collar	346 Lever
315 Tension Spring	347 Pin with Washer
*316 Belt Cup	348 Fibre Washer
317 Belt Cup Bolt	349 Bolt with Nut
319 Lever Pin	350 Handle Grip (3) each
320 Torsion Spring	351 Cable Clip
321 Angle Adjusting Lever	352 Assembly as shown
322 Side Bracket	355 Dirt Deflector, complete
323 1/2" Lock Nut	355-T Top only
324 Spring Washer	355-B Bottom only
325 5/8" Shoulder Bolt	355-R Rubber Flap only
326 Square Base Bar	356 Belt Cup & Guard Assembly
327 Bolt with Nut	357 Guard, Engine Pulley
328 Thumb Screw with Wing Nut	358 Mount Bracket with Bolts
329 Wheel Bracket	*359 Belt Keeper
*330 Model 200 Bolt, Hex Head	360 Throttle & Cable Model 200
430 Model 200 Bolt, Flat Head	361 Throttle & Cable Model 300
*331 Model 300 Bolt, Hex Head	362 Bolt with Nut
431 Model 300 Bolt, Flat Head	363 Grease Fitting with Washer
332 7" B.B Wheel	364 T-Nut (2)
332-B Wheel Bearings only (2)	365 Stud Bolt
333 Shaft Key	366 Front Wheel Bracket
334 2 1/2" x 5/8" Pulley	367 Bolt w/Nut
334-1 2 1/2" x 3/4" Pulley	368 8" x 2.75 Wheel
335 Axle with Nut	369 Axle Bolt and Nut for 8" Wheel
335-1 Axle w/Nut & Spacer for	370 Tilting Lever Limit Bolt w/Nut
Honda GX120 & B&S 3.5 H.P.	371 Axle Bolt and Nut for Model 150
336 Cap Nut	372 8" Wheel Conversion Kit, includes 1 ea.
337 Spacer Tube	#365, 366, 367, 368, 369, 370; 2-ea.
338 Rod with Washers & Pins	#364
	373 Curb Wheel Kit

*Denotes Pre-1977 Models only

**Denotes Pre-1994 Models only

*-Denotes Pre 1977 Models only

OPERATING INSTRUCTIONS

NOTE — Right or left side of machine refers to machine as viewed from the normal operating position behind the handle.

Before starting the engine read engine instruction manual, be sure to fill the crankcase with recommended oil. When starting the engine move the blade control level on handle to the top adjustment hole; this disengages the cutting blade.

To EDGE along a sidewalk the blade should be in a vertical position (fig. 1). Lower the depth control lever until the cutting blade reaches a depth of approximately $\frac{1}{2}$ inch below the sidewalk; this will automatically engage the cutting blade.

To put the blade in a BEVELING position (fig. 2) move the tilting lever, part number 321, to the extreme right hand position and lower the depth control lever to the desired depth.

WHEN TRIMMING position is desired it is important that the engine be stopped and the front wheel be moved to the extreme right side of the frame before moving the blade to a horizontal position. NOTE: Models 208-H, 308, 308-H DO NOT move to trim mode or have an adjustable front wheel assembly.

To put the blade in a TRIMMING position (fig. 3), stop the engine, move the sliding front wheel to the extreme right hand position, move the tilting lever to the extreme bottom position and lower the depth control lever to achieve the desired blade height.

To EDGE around a curve (fig. 4) stop the engine, move the sliding front wheel to the middle position and put the blade in the vertical position. Engage the depth control level to desired depth. Lift the rear wheels slightly and guide the blade carefully around the curve.

To EDGE IVY (fig. 5) leave blade in the vertical position, stop the engine and move sliding front wheel to extreme left hand position enabling the edger to ride a six inch curb. Move depth control lever to desired depth. NOTE: Model 150 DOES NOT have adjustable front wheel and will not ride curb.

Figure 6 illustrates the proper operator position when starting the machine.

Figure 7 illustrates the proper operator position when adjusting the blade depth control and clutch. This is also the normal operating position.

Figure 8 illustrates the proper operator position when adjusting the blade angle adjustment.

Figure 9 illustrates the proper operator position when stopping the engine.

USER MAINTENANCE INSTRUCTIONS

EDGER LUBRICATION:

Oil all points marked O. (fig. 10).

Grease point marked G.

ENGINE: See engine manual.

MODEL 200 SHOWN



FIG. 10

Keep all nuts, bolts and screws tight. Never store the machine with fuel in the fuel tank inside a building where fumes may reach an open flame or sparks, or in a confined space such as a car trunk.

Refer to the engine manual for important details if the product is to be stored for an extended period of time.

INSTRUCTIONS FOR CHANGING BLADE

1. Disconnect the spark plug wire.
2. Use a wrench that snugly fits the blade nut. Place a heavy cloth over the cutting edge and hold the blade securely, turning the nut in a counter-clockwise direction. After removing blade and washers, inspect the washers for excessive wear, replace if needed.
3. Be sure washers and blade are replaced in the exact sequence in which they were removed. If in doubt refer to the parts schematic.

SAVE THESE INSTRUCTIONS

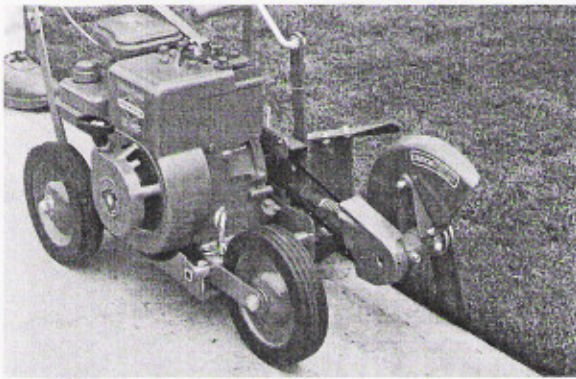

MODEL 200
SHOWN

FIG.
1



FIG.
6

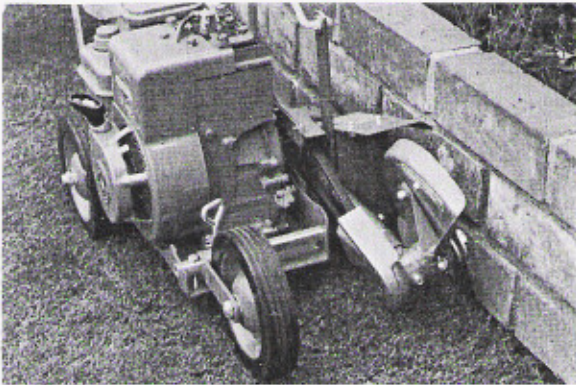

FIG.
2



FIG.
7

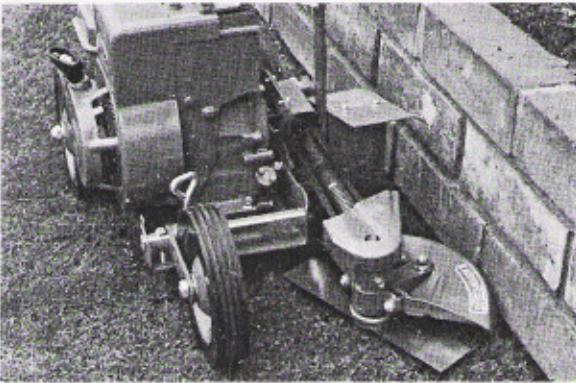

FIG.
3



FIG.
8

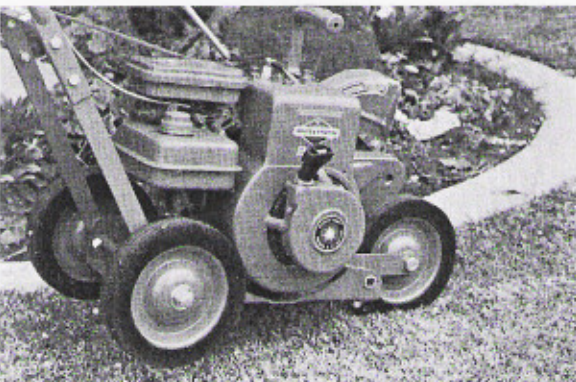

FIG.
4



FIG.
9

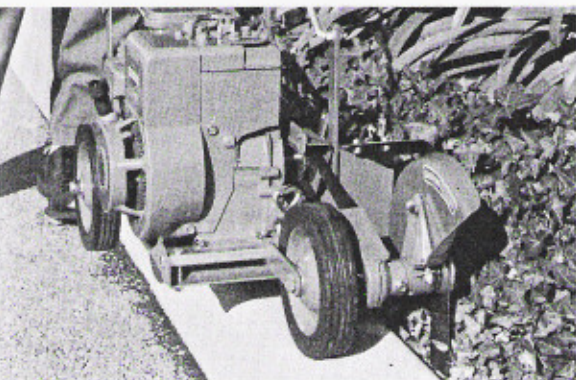

FIG.
5



POWER-TRIM CO. INC.

6841 MARLIN CIRCLE • LA PALMA, CA 90623 • (714) 523-8560 • FAX (714) 994-1821

LIMITED WARRANTY

POWER-TRIM CO., INC. warrants to the original consumer purchaser of its power lawn edgers that such equipment does not contain any defects in material or workmanship:

SUBJECT TO THE FOLLOWING EXCEPTIONS AND CONDITIONS, if any defects in material or workmanship in the equipment purchased by an original consumer purchaser occurs and the equipment is delivered to the Power-Trim dealer from whom the equipment was purchased or to the nearest Power-Trim retailer of this equipment within (2) two years from the date of purchase, Power-Trim Co., Inc. promises that any such defects will be either repaired or, at the option of Power-Trim Co., Inc. replaced, without charge for labor or materials.

EXCEPTIONS :

1. Equipment which is used commercially, in a business pursuit, for rental purposes, or collectively by two or more households is covered by this limited warranty for a period of only ninety (90) days from the date of purchase after which no claim may be made under this warranty.
2. This limited warranty does not include a warranty on the engines of the equipment. Engines are covered by a separate limited warranty from the engine manufacturer which is to accompany each item of equipment.

CONDITIONS :

TO OBTAIN AND PRESERVE YOUR RIGHTS UNDER THIS WARRANTY THE ORIGINAL CONSUMER PURCHASER MUST COMPLY WITH THE FOLLOWING CONDITIONS :

1. Any claim under this limited warranty must be made to the dealer who sold the equipment or to the nearest retailer of Power-Trim equipment within the time limitations of this warranty. To present such a claim, you must deliver to the dealer within the allowable time period the equipment for examination by the dealer.
2. The condition giving rise to the claim under the limited warranty must be for a defect in material or workmanship. For example, abuse, misuse, or alterations to the equipment causing damage to the equipment or its parts may prevent any warranty claim from being honored.
3. Anyone presenting a warranty claim must cooperate with the dealer to whom the claim has been presented, and the warranty claim forms required by the dealer must be signed.
4. All charges for transportation of the equipment to and from the dealer must be paid by the person presenting the warranty claim. Power-Trim Co., Inc. will not be responsible for such transportation charges.

In the event that you are unable to contact the dealer from whom the Power-Trim equipment was purchased and are unable to locate the nearest retail dealer of Power-Trim equipment, you should contact :

POWER-TRIM CO., INC.
6841 Marlin Circle
La Palma, Calif. 90623
(714) 523-8560

DISCLAIMER OF FURTHER WARRANTY

THERE IS NO OTHER EXPRESS WARRANTY. IMPLIED WARRANTIES ARE LIMITED TO TWO YEARS FROM DATE OF ORIGINAL PURCHASE, AND ARE EXCLUDED TO THE EXTENT PERMITTED BY LAW. THERE ARE NO WARRANTIES WHICH EXTEND BEYOND THE DESCRIPTION OF THE PRODUCT CONTAINED HEREIN. IN NO EVENT SHALL THE COMPANY BE LIABLE FOR INDIRECT, SPECIAL OR CONSEQUENTIAL DAMAGES (SUCH AS LOSS OF ANTICIPATED PROFITS) IN CONNECTION WITH THE CONSUMERS USE OF THE PRODUCT.

ISSUED OCTOBER 1, 1989